

LPR | Levers for PR-CH flush pull handles

Steel or stainless steel



STANDARD EXECUTIONS

- LPR: zinc-plated steel lever.
- LPR-SST: AISI 304 stainless steel lever.

Assembly on handle PR-CH

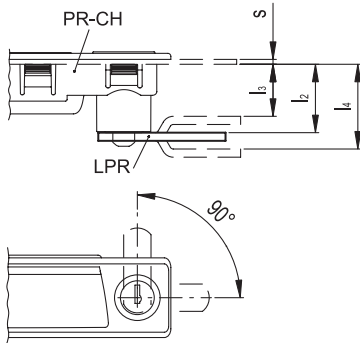

Conversion Table			
1 mm = 0,039 inch			
H			
mm	inch	mm	inch
17.5	0.69	32	1.26
19.8	0.78	32.5	1.28
22	0.87	33	1.30
24.5	0.96	34.5	1.36
26.5	1.04	35.5	1.40
27.8	1.09	45	1.77
30	1.18	46	1.81

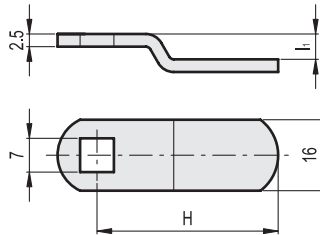

LPR

METRIC

Code	Description	H	l1	s+l2	s+l3	s+l4	⚖
421041	LPR-0-17	17.5	0	23.2	-	-	7
421045	LPR-0-22	22	0	23.2	-	-	8
421049	LPR-0-32	32	0	23.2	-	-	11
421053	LPR-0-46	46	0	23.2	-	-	15
421057	LPR-2-24	24.5	2	-	21.2	25.2	8
421061	LPR-2-28	27.8	2	-	21.2	25.2	10
421065	LPR-2-34	34.5	2	-	21.2	25.2	11
421069	LPR-5-30	30	5	-	18.2	28.2	10
421073	LPR-5-33	33	5	-	18.2	28.2	11
421077	LPR-5-35	35.5	5	-	18.2	28.2	12
421081	LPR-8-32	32.5	8	-	15.2	31.2	13
421085	LPR-12-26	26.5	12	-	11.2	35.2	12

LPR-SST

INOX STAINLESS STEEL METRIC

Code	Description	H	l1	s+l2	s+l3	s+l4	⚖
421046	LPR-0-20-SST	19.8	0	23.2	-	-	8
421050	LPR-0-32-SST	32	0	23.2	-	-	11
421054	LPR-0-46-SST	46	0	23.2	-	-	15
421068	LPR-0-45-SST	45	3	-	20.2	26.2	15